



## General data

Standards	EN 81-20 EN 81-50
Housing material	Light alloy die-casting
Material of the latching bolt	Brass
Gross weight	960 g

## General data - Features

Manual release	Yes
With fail-safe locking system (Y/N)	No
Safety functions	Yes
Number of door leaves	1
Number of safety contacts	1

## Mechanical data

Actuating element	Roller lever H65 and bearing block B
Orientation / Alignment	right-hand model
Mounting	rear-side mounting holes

## Mechanical data - Connection technique

Cable entry	M20 cable gland
Note (Cable entry)	Graphic representation: left version mirror image

## Mechanical data - Dimensions

Width	165 mm
Height	80 mm
Depth	37.5 mm

Diameter of the latching bolt	18 mm
X-dimension of the latching bolt	11.5 mm
Note (X-dimension of the latching bolt)	The entire locking bolt length results from the prescribed insertion depth of the locking bolt into the door leaf of 21 mm and dimension X. Dimension X represents the distance between the bottom of the enclosure of the door closing device and the top of the door.
Latching bolt bevelling, bottom	45 °

## Ambient conditions

Degree of protection	IP20
Ambient temperature	-15 ... +70 °C

## Ambient conditions - Insulation values

Rated insulation voltage $U_i$	400 VAC
Rated impulse withstand voltage $U_{imp}$	6 kV

## Electrical data

Thermal test current	10 A
Utilisation category AC-15	230 VAC
Utilisation category AC-15	2 A
Utilisation category DC-13	200 VDC
Utilisation category DC-13	2 A
Switching element	Opener (NC)
Switching principle	Slow action
Material of the contacts, electrical	Silver

## Accessory

Note (Accessories) Solenoid SOL-AV15/AV18 for electrical actuation available as accessory

## Note

Note (Manual release) For manual release using M5 triangular key, available as accessory

## Ordering code

Product type description:  
AV18(1)(2)K(3)U-GB215

(1)

---

<b>L</b>	left-hand model
<b>R</b>	right-hand model

(2)

---

<b>without</b>	Pull strap
<b>H</b>	Lever H65
<b>H92</b>	Lever H92
<b>H105</b>	Lever H105
<b>B</b>	Bearing block B
<b>B2</b>	Bearing block B2

(3)

---

<b>X11,5</b>	X-dimension of the latching bolt = 11,5 mm
<b>X20</b>	X-dimension of the latching bolt = 20 mm
<b>X30</b>	X-dimension of the latching bolt = 30 mm
<b>X40</b>	X-dimension of the latching bolt = 40 mm
<b>X45</b>	X-dimension of the latching bolt = 45 mm

**Note:**

---

U = interlock bevel on the underside  
GB215 = additional, front-side M8 mounting holes

Variants that differ from this are special versions.  
Availability on request.

## Pictures

### Product picture (catalogue individual photo)

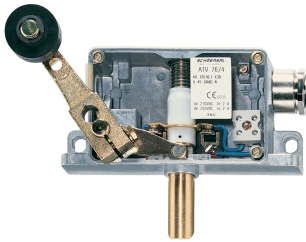

ID: kav18f01

| 543.2 kB | .jpg | 352.778 x 284.692 mm - 1000 x 807 px - 72 dpi

| 35.4 kB | .png | 74.083 x 59.972 mm - 210 x 170 px - 72 dpi

| 61.6 kB | .jpg | 123.472 x 99.483 mm - 350 x 282 px - 72 dpi

### Dimensional drawing basic component

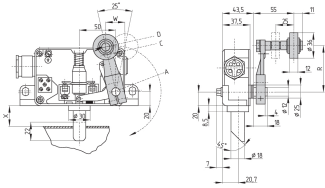

ID: 5av18g02

| 55.3 kB | .cdr |

| 11.5 kB | .png | 74.083 x 41.628 mm - 210 x 118 px - 72 dpi

| 152.5 kB | .jpg | 352.778 x 198.614 mm - 1000 x 563 px - 72 dpi

### Images (miscellaneous)

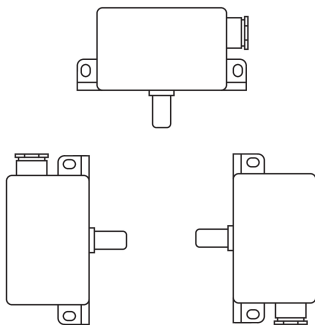

ID: kav18m02

| 68.6 kB | .jpg | 352.425 x 360.892 mm - 999 x 1023 px - 72 dpi

### Assembly example



ID: kav--m03

| 23.5 kB | .cdr |

Schmersal India Pvt. Ltd., Plot No - G-7/1, Ranjangaon MIDC, Tal. - Shirur, Dist.- Pune 412 220

The details and data referred to have been carefully checked. Images may diverge from original. Further technical data can be found in the manual. Technical amendments and errors possible.

Generated on: 16/09/2024, 5:31 am