



BN 120L-01Z/V 2,0M

- Actuation from front
- with bias magnet
- Non-contact principle
- Long life
- Thermoplastic enclosure
- Actuating distance up to 60 mm depending on actuating magnet and version
- Design Ø 10.7 mm
- with central mounting
- With pre-wired cable

Data

Ordering data

Product type description BN 120L-01Z/V 2,0M

Article number (order number) 101210881

EAN (European Article Number) 4030661388458

eCl@ss number, version 12.0 27-27-43-02

eCl@ss number, version 11.0 27-27-01-05

eCl@ss number, version 9.0 27-27-01-05

ETIM number, version 7.0 EC002544

ETIM number, version 6.0 EC002544

General data

Working principle	Magnetic drive
Housing construction form	Cylinder, thread
Housing material	Glass-fibre, reinforced thermoplastic
Gross weight	56 g

General data - Features

Suitable for elevators	Yes
bias magnet	Yes
Number of normally closed (NC)	1

Mechanical data

Actuating panels	front side
Actuating element	Magnet
Mechanical life, minimum	10,000,000 Operations
Actuating speed, maximum	18 m/s
Mounting	central with threaded flange M12 x 1
Tightening torque of nuts, maximum	0.9 Nm

Mechanical data - Switching distances according EN IEC 60947-5-3

Switching distance S_n	5 mm ... 55 mm
	BP 10S = 5 mm
	2 x BP 10S = 10 mm
	BP 15S = 6 mm
	BP 34S = 20 mm
	BP 20S = 15 mm
	BP 31S = 15 mm
	BP 11S = 5 mm
	2 x BP 11S = 15 mm
	BP 12S = 10 mm
	2 x BP 12S = 25 mm
	BP 21S = 30 mm
	2 x BP 21S = 20 ... 55 mm
	BP 22S = 25 mm
	2 x BP 22S = 15 ... 55 mm
	BE 20 S = 6 mm

Note (Switching distance S_n) Actuating distance up to 55 mm depending on actuating magnet and version. The specified switching distances are applicable for the actuation of individually mounted components without ferromagnetic influence. A change of the distance, either positive or negative, is possible due to ferromagnetic influences. The mutual interference between multiple actuating magnets must be observed.

Repeat accuracy R 0.3 mm

Mechanical data - Connection technique

Length of cable	2 m
Termination	Cable
Wire cross-section	0.25 mm ²
Wire cross-section	23 AWG
Material of the Cable mantle	LiYY

Mechanical data - Dimensions

Diameter of sensor	10.7 mm
width across flats	17 BK
Length of sensor	102 mm

Ambient conditions

Degree of protection	IP67
Ambient temperature	-25 ... +70 °C

Resistance to vibrations 10 ... 55 Hz, amplitude 1 mm

Resistance to shock 30 g / 11 ms

Electrical data

Switching voltage, maximum 200 VAC

Switching voltage, maximum 200 VDC

Switching current, maximum 1 A

Switching capacity, maximum 30 W

Switching capacity, maximum 30 VA

Switching element Opener (NC)

Electrical data - Digital Output

Design of control elements Reed contacts

Scope of delivery

Scope of delivery Actuator must be ordered separately.

Accessory

Recommendation (actuator)	BP 10 S 2x BP 10 S BP 15 S BP 34 S BP 20 S BP 31 S BP 11 S 2x BP 11 S BP 12 S 2x BP 12S BP 21 S 2x BP 21 S BP 22 S 2x BP 22 S BE 20 S
------------------------------	---

Recommendation (actuator, lift switchgear)	BP 10 2 x BP 10 BP 15 BP 34
--	--------------------------------------

Note

Note (General)

The opening and closing functions depend on the direction of actuation, the actuating magnets and the polarity of the actuating magnets.
When the switches and actuators come together, the colours must coincide: Red (S) to red (S) and green (N) to green (N). This does not apply to the bistable contact.
The switch is to be mounted on iron with a non-magnetic layer of at least 20 mm.

Pictures

Product picture (catalogue individual photo)



ID: kbn12f03

| 221.1 kB | .jpg | 91.722 x 529.167 mm - 260 x 1500 px - 72 dpi

| 170.1 kB | .png | 74.083 x 427.214 mm - 210 x 1211 px - 72 dpi

| 13.4 kB | .jpg | 21.519 x 123.472 mm - 61 x 350 px - 72 dpi

Dimensional drawing basic component

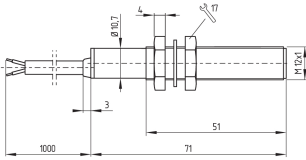

ID: 1bn12g04
 | 23.3 kB | .cdr |
 | 3.1 kB | .png | 74.083 x 51.153 mm - 210 x 145 px - 72 dpi
 | 68.5 kB | .jpg | 352.778 x 243.769 mm - 1000 x 691 px - 72 dpi

Switch travel diagram

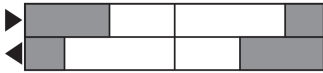

ID: ksbn4sx2
 | 18.1 kB | .cdr |
 | 1.1 kB | .png | 74.083 x 18.697 mm - 210 x 53 px - 72 dpi
 | 24.2 kB | .jpg | 352.778 x 88.194 mm - 1000 x 250 px - 72 dpi

Diagram

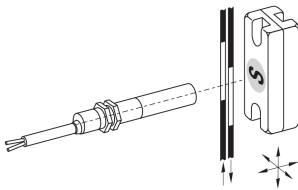

ID: 1bn12k06
 | 24.2 kB | .cdr |
 | 72.9 kB | .jpg | 352.778 x 243.769 mm - 1000 x 691 px - 72 dpi
 | 9.4 kB | .png | 74.083 x 51.153 mm - 210 x 145 px - 72 dpi

Characteristic curve

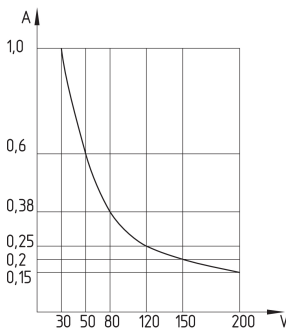

ID: kbn65d03
 | 2.9 kB | .png | 73.731 x 84.314 mm - 209 x 239 px - 72 dpi
 | 112.6 kB | .jpg | 352.425 x 402.167 mm - 999 x 1140 px - 72 dpi

Schmersal India Pvt. Ltd., Plot No - G-7/1, Ranjangaon MIDC, Tal. - Shirur, Dist.- Pune 412 220

The details and data referred to have been carefully checked. Images may diverge from original. Further technical data can be found in the manual. Technical amendments and errors possible.

Generated on: 22/08/2024, 2:05 pm