



BN 75-01Z-1391

- with Pre-wired cable
- Non-contact principle
- 1 Reed kontakts
- Long life
- 80 mm x 99,5 mm x 55 mm
- Float switch
- Thermoplastic enclosure
- Available with M12 plug-in connector and pre-wired cable

Data

Ordering data

Product type description	BN 75-01Z-1391
Article number (order number)	101055741
EAN (European Article Number)	4030661009391
eCl@ss number, version 12.0	27-27-43-02
eCl@ss number, version 11.0	27-27-01-05
eCl@ss number, version 9.0	27-27-01-05
ETIM number, version 7.0	EC002544
ETIM number, version 6.0	EC002544

General data

Working principle	Magnetic drive
Housing construction form	Special construction
Housing material	Glass-fibre, reinforced thermoplastic
Active area	Plastic
Gross weight	127 g

General data - Features

Number of normally closed (NC) 1

Mechanical data

Actuating element Magnet
Mechanical life, minimum 1,000,000,000 Operations

Mechanical data - Switching distances according EN IEC 60947-5-3

Hysteresis (Switching distance), maximum 3 mm

Mechanical data - Connection technique

Termination Pre-wired cable

Mechanical data - Dimensions

Length of sensor 55 mm
Width of sensor 80 mm
Height of sensor 99.5 mm

Ambient conditions

Degree of protection IP67
Ambient temperature -25 ... +80 °C

Electrical data

Switching voltage, maximum 220 VAC
Switching current, maximum 1 A
Switching capacity, maximum 60 W
Switching capacity, maximum 60 VA
Switching element Opener (NC)

Bounce duration, minimum 0.3 ms

Bounce duration, maximum 0.6 ms

Electrical data - Digital Output

Design of control elements Reed contacts

Note

Note (General)

Depending on how the floater is assembled, either a NO contact or a NC contact is possible.

The indicated switching points are applicable for water

Pictures

Product picture (catalogue individual photo)



ID: kbn75f01

| 560.2 kB | .jpg | 352.778 x 529.167 mm - 1000 x 1500 px - 72 dpi

| 48.7 kB | .png | 74.083 x 111.125 mm - 210 x 315 px - 72 dpi

| 34.8 kB | .jpg | 82.197 x 123.472 mm - 233 x 350 px - 72 dpi

Dimensional drawing basic component

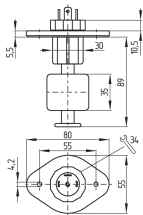

ID: 1bn75g01

| 24.8 kB | .cdr |

| 4.0 kB | .png | 74.083 x 51.153 mm - 210 x 145 px - 72 dpi

| 79.9 kB | .jpg | 352.778 x 244.475 mm - 1000 x 693 px - 72 dpi

Diagram

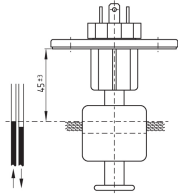

ID: 1bn75k02

| 22.4 kB | .cdr |

| 50.7 kB | .jpg | 352.778 x 244.475 mm - 1000 x 693 px - 72 dpi

| 5.3 kB | .png | 74.083 x 51.153 mm - 210 x 145 px - 72 dpi

Characteristic curve

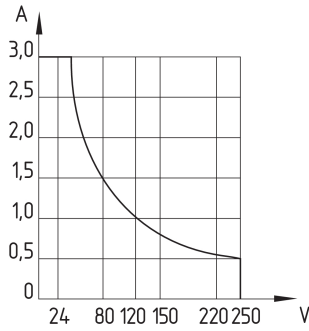

ID: kbn32d01

| 110.5 kB | .jpg | 352.425 x 371.828 mm - 999 x 1054 px - 72 dpi

Schmersal India Pvt. Ltd., Plot No - G-7/1, Ranjangaon MIDC, Tal. - Shirur, Dist.- Pune 412 220

The details and data referred to have been carefully checked. Images may diverge from original. Further technical data can be found in the manual. Technical amendments and errors possible.

Generated on: 22/08/2024, 2:01 pm