



BN 85-R-1824-1 5,0M

- Mounting on C DIN rail and sheathed cable without screws
- Non-contact principle
- 1 Reed kontakts
- Long life
- Actuating distance up to 40 mm depending on actuating magnet and version
- 40 mm x 35 mm x 16,5 mm
- Thermoplastic enclosure
- Reed-contact to clip-in, on-location assembly

Data

Ordering data

Product type description	BN 85-R-1824-1 5,0M
Article number (order number)	101095158
EAN (European Article Number)	4030661023496
eCl@ss number, version 12.0	27-27-43-02
eCl@ss number, version 11.0	27-27-01-05
eCl@ss number, version 9.0	27-27-01-05
ETIM number, version 7.0	EC002544
ETIM number, version 6.0	EC002544

General data

Working principle	Magnetic drive
-------------------	----------------

Housing construction form	Block
Housing material	Glass-fibre, reinforced thermoplastic
Gross weight	130 g

General data - Features

Latching	Yes
Suitable for elevators	Yes
Number of snap-in contacts	1

Mechanical data

Actuating panels	front side
Active area	lateral
Actuating element	Magnet
Mechanical life, minimum	1,000,000,000 Operations
Mounting	Mounting to C profile rails and sheathed cable without screws

Mechanical data - Switching distances according EN IEC 60947-5-3

Switching distance S_n	2 mm ... 40 mm
	BP 6S = 2 ... 12 mm
	BP 8S = 2 ... 10 mm
	BP 10S = 5 ... 20 mm
	2 x BP 10S = 6 ... 27 mm
	BP 15S = 5 ... 22 mm
	2 x BP 15S = 7 ... 28 mm
	BP 34S = 10 ... 40 mm
	BP 20S = 3 ... 28 mm
	BP 31S = 4 ... 30 mm
	BP 11S = 4 ... 23 mm
	BP 12S = 5 ... 27 mm

Note (Switching distance S_n) Actuating distance up to 40 mm depending on version and actuating magnet

Mechanical data - Connection technique

Length of cable	5 m
-----------------	-----

Termination	Cable
Wire cross-section	0.75 mm ²
Wire cross-section	18 AWG
Material of the Cable mantle	LiY

Mechanical data - Dimensions

Length of sensor	16.5 mm
Width of sensor	40 mm
Height of sensor	35 mm

Ambient conditions

Degree of protection	IP40
Ambient temperature	+0 ... +75 °C
Resistance to shock	60 g, on sine wave oscillation

Electrical data

Switching voltage, maximum	60 VDC
Switching current, maximum	1 A
Switching capacity, maximum	30 VA
Switching element	bistable contact
Bounce duration, maximum	0.2 ms

Electrical data - Digital Output

Design of control elements	Reed contacts
----------------------------	---------------

Scope of delivery

Scope of delivery

Actuator must be ordered separately.

Accessory

Recommendation (actuator)	BP 10 S
	2x BP 10 S
	BP 15 S
	BP 34 S
	BP 20 S
	BP 31 S
	BP 11 S
	BP 12 S
	BP 6 S
	BP 8 S
	2 x BP 15 S

Note

Note (General)

The opening and closing functions depend on the direction of actuation, the actuating magnets and the polarity of the actuating magnets.

Pictures

Product picture (catalogue individual photo)



ID: kbn85f04

| 227.6 kB | .jpg | 352.778 x 130.528 mm - 1000 x 370 px - 72 dpi

| 28.7 kB | .png | 74.083 x 27.517 mm - 210 x 78 px - 72 dpi

Dimensional drawing basic component

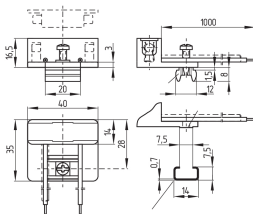

ID: 1bn85g02

| 36.1 kB | .cdr |

| 10.0 kB | .png | 74.083 x 51.153 mm - 210 x 145 px - 72 dpi

| 122.1 kB | .jpg | 352.778 x 243.769 mm - 1000 x 691 px - 72 dpi

Dimensional drawing basic component

