



AZ216-Z12R

- small body
- thermoplastic enclosure with foldable latching cover
- Actuator heads can be repositioned in steps 4 x 90°
- Different contact options
- Latching force 12N or 30N depending on variant

Data

Ordering data

| | |
|-------------------------------|---------------|
| Product type description | AZ216-Z12R |
| Article number (order number) | 103053362 |
| EAN (European Article Number) | 4030661634456 |
| eCl@ss number, version 12.0 | 27-27-06-10 |
| eCl@ss number, version 11.0 | 27-27-06-10 |
| eCl@ss number, version 9.0 | 27-27-06-10 |
| ETIM number, version 7.0 | EC002592 |
| ETIM number, version 6.0 | EC002592 |

Approvals - Standards

| | |
|--------------|--------------|
| Certificates | cULus CCC |
|--------------|--------------|

General data

| | |
|--|--|
| Standards | EN ISO 13849-1 EN ISO 14119 EN IEC 60947-5-1 |
| Coding level according to EN ISO 14119 | Low |

| | |
|-------------------|---|
| Working principle | electromechanical |
| Housing material | Plastic, glass-fibre reinforced thermoplastic, self-extinguishing |

General data - Features

| | |
|------------------------------|---|
| Number of auxiliary contacts | 1 |
| Number of safety contacts | 2 |
| Number of cable glands | 1 |

Safety classification

| | |
|---|--------------------------------------|
| Standards | EN ISO 13849-1 |
| Performance Level, up to | c |
| Category | 1 |
| B _{10D} Normally-closed contact (NC) | 2,000,000 Operations |
| B _{10D} Normally-open contact (NO) | 1,000,000 Operations |
| Note | at 10% I _e and ohmic load |
| Mission time | 20 Year(s) |

Safety classification - Fault exclusion

| | |
|--------------------------|---|
| Please note: | Can be used when fault exclusion for dangerous damage to the 1-channel mechanism is permissible and sufficient protection against manipulation is guaranteed. |
| Performance Level, up to | d |
| Category | 3 |
| Note | for 2-channel use and with suitable logic unit. |

Mechanical data

| | |
|--------------------------|----------------------|
| Mechanical life, minimum | 1,000,000 Operations |
| Latching force | 30 N |
| Positive break travel | 5 mm |

| | |
|--|---------|
| Positive break force per NC contact, minimum | 10 N |
| Positive break force, minimum | 10 N |
| Actuating speed, maximum | 0.2 m/s |
| Mounting | Screws |
| Type of the fixing screws | 2x M4 |
| Tightening torque of the fixing screws | 1.2 Nm |

Mechanical data - Connection technique

| | |
|---|---|
| Termination | Screw terminals M20 x 1.5 |
| Cable entry | 1 x M20 x 1,5 |
| Termination | Screw terminals |
| Cable section, minimum | 0.34 mm ² |
| Cable section, maximum | 1.5 mm ² |
| Note | All indications including the conductor ferrules. |
| Tightening torque of electrical connection, minimum | 0.6 Nm |
| Tightening torque of electrical connection, maximum | 0.8 Nm |
| Note (Cable entry) | Settle length of the conductor: 5...6mm |
| Allowed type of cable | solid single-wire solid multi-wire flexible |

Mechanical data - Dimensions

| | |
|------------------|---------|
| Length of sensor | 32.7 mm |
| Width of sensor | 31 mm |
| Height of sensor | 104 mm |

Ambient conditions

| | |
|----------------------|----------------|
| Degree of protection | IP66 IP67 |
| Ambient temperature | -30 ... +80 °C |

Storage and transport temperature -40 ... +85 °C

Permissible installation altitude above sea level, maximum 2,000 m

Ambient conditions - Insulation values

Rated insulation voltage U_i 300 VAC

Rated impulse withstand voltage U_{imp} 4 kV

Overvoltage category III

Degree of pollution 3

Electrical data

Thermal test current 5 A

Required rated short-circuit current 400 A

Switching element 1 NO contact, 2 NC contacts

Note (Switching element) Change-over contact with double break, type Zb or 3 NC contacts, with galvanically separated contact bridges

Switching principle Snap action

Maximum switching frequency 1,200 /h

Material of the contacts, electrical Silver

Electrical data - Safety contacts

Voltage, Utilisation category AC-15 230 VAC

Current, Utilisation category AC-15 3 A

Voltage, Utilisation category DC-13 24 VDC

Current, Utilisation category DC-13 3 A

Electrical data - Auxiliary contacts

Voltage, Utilisation category AC- 230 VAC
15

Current, Utilisation category AC- 3 A
15

Voltage, Utilisation category DC- 24 VDC
13

Current, Utilisation category DC- 3 A
13

Other data

| | |
|---------------------|--|
| Note (applications) | sliding safety guard removable guard hinged safety guard |
|---------------------|--|

Scope of delivery

| | |
|-------------------|--|
| Scope of delivery | Actuator must be ordered separately. Slot cover for dust-proof covering of the opening not in use |
|-------------------|--|

Pictures

Product picture (catalogue individual photo)



ID: kaz21f02

| 764.3 kB | .jpg | 352.778 x 798.336 mm - 1000 x 2263 px - 72 dpi

| 64.9 kB | .png | 74.083 x 167.569 mm - 210 x 475 px - 72 dpi

Dimensional drawing basic component

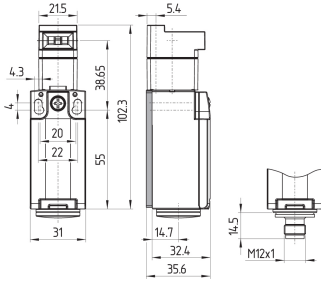

ID: kaz21xg01

| 142.8 kB | .jpg | 352.778 x 304.8 mm - 1000 x 864 px - 72 dpi

Dimensional drawing basic component

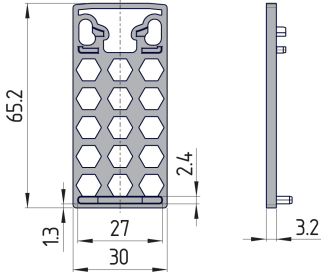

ID: kaz21xg02

| 167.8 kB | .jpg | 352.778 x 298.803 mm - 1000 x 847 px - 72 dpi

Diagram

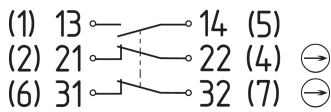

ID: kps2xk22

| 81.5 kB | .jpg | 352.778 x 133.703 mm - 1000 x 379 px - 72 dpi

| 3.8 kB | .png | 74.083 x 28.222 mm - 210 x 80 px - 72 dpi

Detail photo

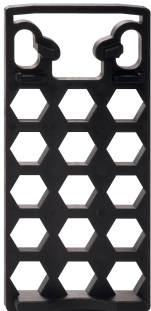

ID: kaz2x3xf05

| 660.4 kB | .jpg | 352.778 x 709.083 mm - 1000 x 2010 px - 72 dpi

| 86.7 kB | .png | 74.083 x 148.872 mm - 210 x 422 px - 72 dpi

Schmersal India Pvt. Ltd., Plot No - G-7/1, Ranjangaon MIDC, Tal. - Shirur, Dist.- Pune 412 220

The details and data referred to have been carefully checked. Images may diverge from original. Further technical data can be found in the manual. Technical amendments and errors possible.

Generated on: 27/08/2024, 9:16 am