

## MZERO 16.4

Order Code: 1100005

Stand-Alone Master Unit. 16 Digital Inputs. 4 OSSD pairs (SIL 3). 4 Status Outputs. 4 Test Outputs. Screw Terminal Blocks



Safety level

PL e

Safety inputs

16 digital inputs

Safety outputs

4 OSSD pairs (400 mA)

Status outputs

4 PNP (100 mA)

Test outputs

4

## Technical Description

Stand-Alone Master Unit to control smaller machinery connecting with up to 4 safety devices, i.e. 1 safety light curtain, 1 e-stop, 1 magnetic sensor and 1 two-hand switch

## Features

Safety level	PL e
Safety inputs	16 digital inputs
Safety level (SIL / PL)	SIL 3 - SILCL 3 - PL e - Cat. 4
Operating temperature (°C)	- 10 ... 55
Signalling	LEDs indication for operating status and fault diagnosis. LED indication of the: inputs, OSSD outputs, reset request and status outputs condition
Safety output type	4 pairs OSSD PNP (400 mA at 24 VDC) with protection against short circuit, overload and reverse polarity
Connections	Removable terminal blocks, screw contacts
MTTFD (ISO13849) years	154,51
PFHD (IEC 61508)	1,53E-08
Safety outputs	4 OSSD pairs (400 mA)
Status outputs	4 PNP (100 mA)
Test outputs	4
Storage temperature (°C)	-20 ... +85
MSC connector provided	No
Start/Restart inputs and EDM	4 (Moreover allows single input device connections)
Housing for MCM	No
USB input	Yes
Packaging dimensions HxLxW (mm)	58 x 127 x 113
Product class	C

## MZERO 16.4

Custom tariff

85371091

## Electrical data

Power supply (VDC)

24 ± 20%

## Mechanical data

Dimensions HxWxD (mm)

108 x 45 x 114,5

Degree of protection

IP20 for housing - IP2X for terminal block

Fastening

35 mm DIN rail fastening according to EN 50022-35 standard

Gross weight (g)

316,3

Technical drawings

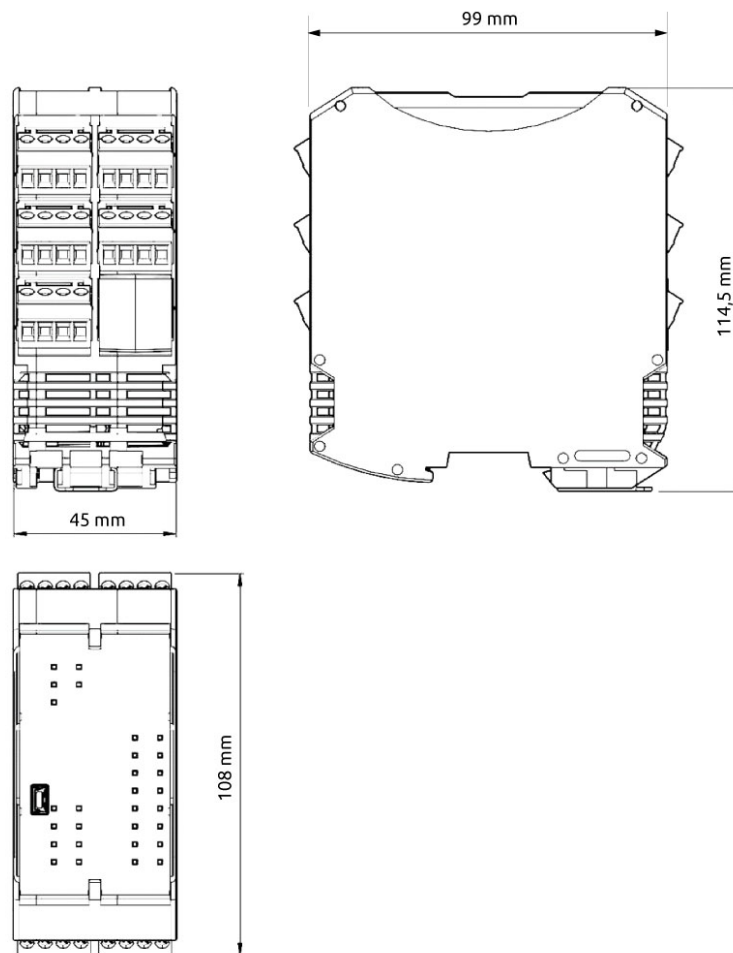

**Certificates**

